

## Hydraulic accelerator, 3-way plastic relay-valve

The 25-300 is a 3-way, hydraulically operated, diaphragm actuated normally close relay-valve which is designed to meet the requirements of hydraulic valves control functions, particularly when fast reaction is required. The body contains two seats, a fully supported frictionless diaphragm and a guided shaft. When pressure command is applied one disc forms a tight seal with the valve seat and when vented the other disc seals drop tight.

### Features

- A 3-way relay-valve designed for accelerate the response of the valve function
- Receives remote commands and activates the hydraulic valve as its location, thereby accelerates reaction time
- Extremely large water passages
- Typically used in irrigation and filtration systems
- Tough and durable construction
- High-grade materials
- Internal trim designed for easy disassembly and maintenance, by removing the bonnet and pulling out trim
- Can be used with any hydraulic control valve
- Simple design

### Typical applications

- Hydraulic Remote Control Valve - RC
- Accelerator for ON/OFF commands

### Technical data

General	
Pressure rating	12 bar / 175 psi
Operating pressure range	1 - 12 bar / 15 - 175 psi
Command / line pressures ratio	1:3
Fluid temperature	60°C max. / 140°F max.
Weight	139 g / 0.31 lbs
Materials	
Body and bonnet	GPR
Elastomers	NBR
Internal parts	GRP / NBR
Spring	SST
Dimensions	
H (Height) max.	77 mm / 3.10"
W (Width)	58 mm / 2.28"
Port Connections	
1	NPT 1/8"
2, 3, 4, 5	NPT 3/8"

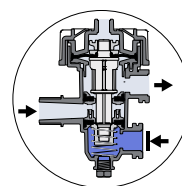

De-pressurized command

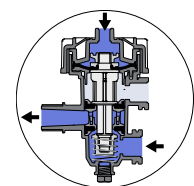

Pressurized command

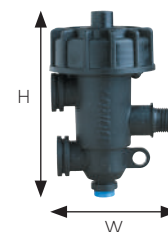

## Installation

### Main components

#	Description
1	Self flushing filter
2	Isolation ball valve
3	25-300 Pilot valve

### Connections

Port	Relay N.C.
1	Pressure command
2	Vent
3	Valve Control Chamber
4	Upstream

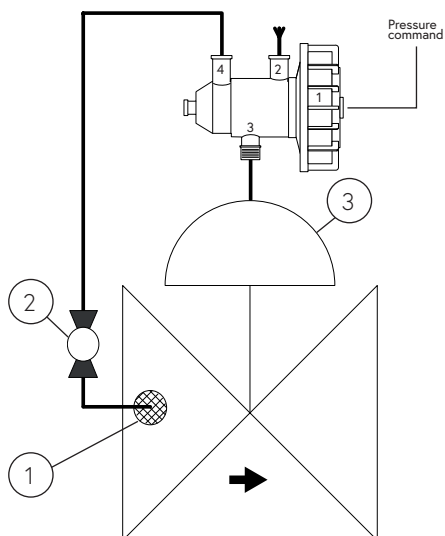

The main valve is normally open and closes by pressure command.  
Sample drawing. Consult Dorot for the assembly design to fit your needs.

## Catalogue numbers

Description	Catalogue number
Locking nut	0050225300
Bonnet	0050225300
Internal parts kit	661202530000000
Spring	0022017316
Body kit	661012530000000

## Spare parts

Locking nut

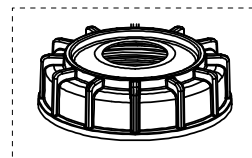

Bonnet

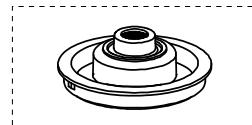

Internal parts kit

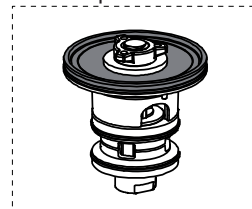

Spring

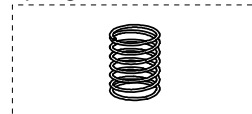

Body kit

